

THIS DRAWING IS UNPUBLISHED. RELEASED FOR PUBLICATION
 © COPYRIGHT BY TYCO ELECTRONICS CORPORATION. ALL RIGHTS RESERVED.

LOC	DIST	REVISIONS					
		P	LTR	DESCRIPTION	DATE	DWN	APVD
G	86		M	REV PER ECR 08-004875	26FEB08	JR	MS

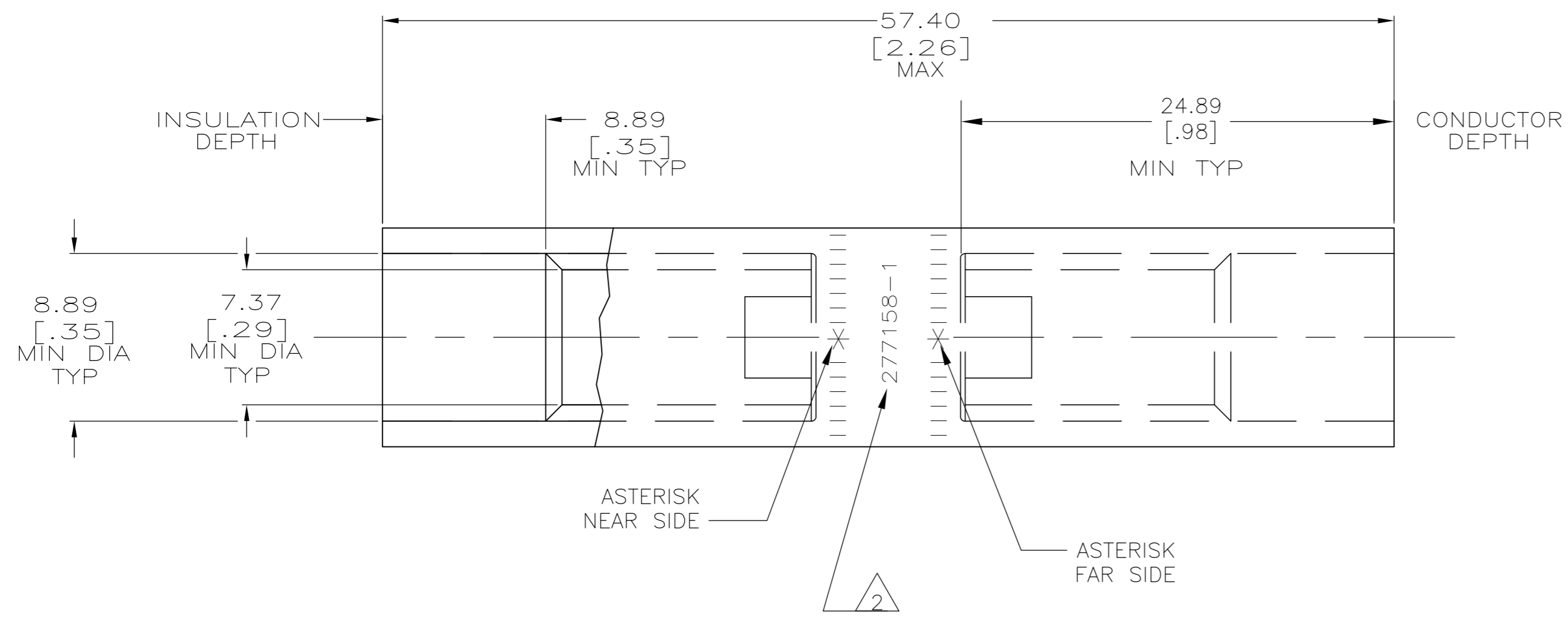

1 WIRE INSULATION: 7.01[.276] - 7.75[.305] DIA
 2 STAMP " 277158-1 AMP 4AL-6CU"
 LOCATED APPROX AS SHOWN

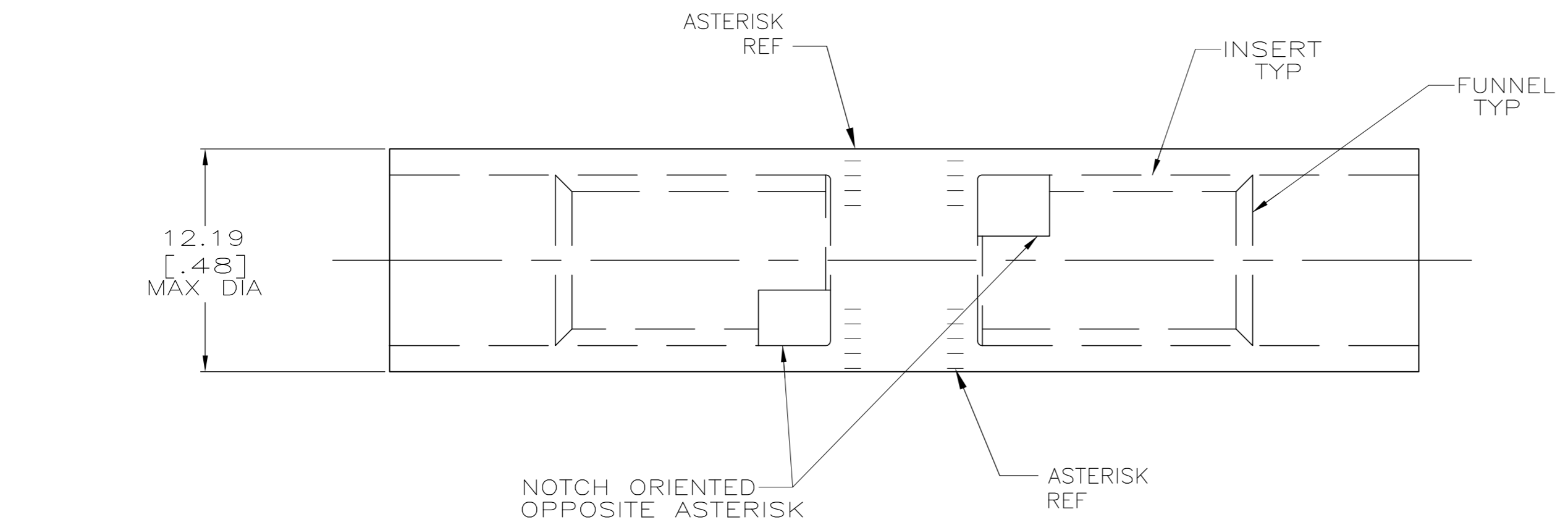

<u>SPLICE:</u> COPPER ASTM B-187 TIN PL ASTM B545, 0.00381[.000150] MIN THK	277158-1
<u>INSERT & FUNNEL:</u> BRASS ASTM B36 NICKEL PL SAE AMS QQ-N-290A, DATED JULY 2000, 0.00254 [.000100] MIN THK	
MATERIAL & FINISH	
	PART NO.

THIS DRAWING IS A CONTROLLED DOCUMENT.		DWN DK SCHRUM 7/5/89	Tyco Electronics Corporation Harrisburg, Pa 17105-3608	
DIMENSIONS: mm [INCHES]		CHK MS FEHER 5/1/90	NAME	
TOLERANCES UNLESS OTHERWISE SPECIFIED:		APVD -	PRODUCT SPEC	
0 PLC ± -			108-11011	
1 PLC ± -			APPLICATION SPEC	
2 PLC ± -			114-2134	
3 PLC ± -			WEIGHT 26.8 GRAMS	
4 PLC ± -			SCALE 4:1 SHEET 1 OF 1 REV M	
FINISH			CUSTOMER DRAWING	
SEE TABLE			SIZE CAGE CODE DRAWING NO RESTRICTED TO	
			A2 00779 C=277158	